

# Crane

## TOP FILL

## Ultrasonic Humidifier

EE-6909



**If you have any questions about the operation of your humidifier, please contact Crane Customer Care.**

**Toll Free:** 888-599-0992

**Email:** [customer-service@crane-usa.com](mailto:customer-service@crane-usa.com)

Register Your Product Online  
<https://crane-usa.com/product-registration/>



# **SAVE YOUR DATED PROOF OF PURCHASE**

**PLEASE READ AND SAVE ALL INSTRUCTIONS TO ENSURE THE SAFE AND EFFECTIVE USE OF THIS HUMIDIFIER.**

[ You will need this in case of warranty ]

staple  
tape  
or paperclip  
your  
receipt  
HERE

# TABLE OF CONTENTS

Table of Contents & Sustainability	P. 1
Safety Instructions	P. 2-3
List of Main Parts	P. 4
Technical Specifications, Assembly & Use	P. 5-6
Maintenance & Storing Your Humidifier	P. 7
Customer Care & Trouble Shooting	P. 8
Warranty	P. 9

## CRANE & SUSTAINABILITY

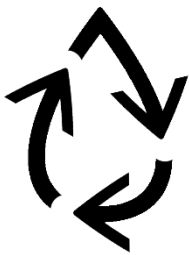

Crane USA is dedicated to your environment both inside and outside your home. We know if cleaned and maintained properly, our products last for years helping to reduce unnecessary use of resources and emissions making new products.

The Crane manual you are holding is from recycled materials with no added finishes or harmful dyes. If the humidifier should no longer operate, please be sure to dispose of the unit in an environmentally friendly way by taking it to a public collection point.

**PLEASE DO NOT PLACE BROKEN HUMIDIFIERS WITH YOUR REGULAR HOUSEHOLD WASTE.**

# IMPORTANT SAFETY INSTRUCTIONS



**WARNING!** READ AND SAVE THESE INSTRUCTIONS. Failure to follow all of the instructions listed below may result in electric shock, fire and/or serious personal injury.

1. It is advisable to carry humidifier with two hands.
2. **DO NOT operate outdoors. This humidifier is intended for indoor use only.**
3. Always have water in the Water Tank when operating the unit.
4. Use only clean, cool tap water to fill the Humidifier body (filtered or distilled water is recommended to avoid white dust if tap water is too hard. **DO NOT use hot water.**
5. Always have the Top Cover and Mist Lid in place while the unit is operating. Place the humidifier so the mist aims away from children, walls, furniture and electrical appliances.
6. Use only a 110-120VAC outlet.  
\* **ALWAYS plug and unplug unit with dry hands to avoid electric shock.**
7. Never operate the unit with a damaged cord or plug.
8. Always place the unit on a smooth, flat, lint-free, non-metallic, waterproof and level surface and position unit away from direct sunlight. Keep the cord away from heated surfaces and areas where it could be walked on or tripped over. Unplug the unit when not in use and whenever you clean or move the unit.
9. Do not add medication of any type into this humidifier. Do not cover any openings on the unit or insert objects into any openings.
10. The unit should not be left unattended in a closed room as the air could become saturated and leave condensation on walls or furniture. Leave room door partly open when humidifier is being operated.
11. When cleaning the inside of the humidifier, keep water away from the Fan Vent. **Turn off and unplug the humidifier to wipe the exterior** (except the electrical controls) with a damp cloth. Humidifier requires regular cleaning. Please refer to the CLEANING INSTRUCTIONS in this manual.
12. Do not tilt or tip the humidifier or attempt to empty or fill it while it is in operation. Do not remove the cover from the unit while it is on.
13. Do not inhale the mist/vapor expelled from the humidifier or drink water from the tank.
14. Do not use a detergent to clean any parts of the unit that contain water. Detergent film dissolved in the water supply can interfere with the output of the unit. Instead, always use white vinegar mixed with water to clean the humidifier.

## SAVE THESE INSTRUCTIONS!

# GENERAL SAFETY INSTRUCTIONS



**WARNING!** Read and understand all instructions. Failure to follow all instructions listed below may result in electric shock, fire or serious personal injury. The warnings, cautions, and instructions discussed in this instruction manual cannot cover all possible conditions and situations that may occur. It must be understood by the user that common sense and caution are a factor which cannot be built into this product, but must be supplied by the user.

## THIS HUMIDIFIER IS NOT A TOY!

**Do not let your child play with this humidifier.** Serious injury and electrocution might be possible. This humidifier has to be operated by an adult only. Children should be supervised to ensure that they do not play with the humidifier.

### SAVE ALL INSTRUCTIONS!

**CAUTION:** A short Power Supply Cord is provided to reduce the risk of personal injury resulting from becoming entangled in or tripping over a longer cord. Extension cords are available from local hardware stores and may be used if care is exercised in their use. If an extension cord is required, special care and caution is necessary. Also the extension cord must be (1) marked with an electrical rating of 125 V and at least 13 A., 1625 W., and (2) the cord must be arranged so that it will not drape over the countertop or tabletop where it can be pulled on by children or accidentally tripped over.

#### ELECTRIC POWER

If the electric circuit is overloaded by other appliances, your humidifier and/or appliances may not operate properly. The humidifier should be operated on a separate electrical circuit from other operating appliances.

#### POLARIZED PLUG

This humidifier has a polarized plug (one blade is wider than the other). As a safety feature to reduce the risk of electrical shock, this plug is intended to fit in a polarized outlet only one way. If the plug does not fit fully in the outlet, reverse the plug. If it still does not fit, contact a qualified electrician. Do not attempt to defeat this safety feature.



### SAFETY WARNING

Although your humidifier is easy to operate, for your safety, the below warnings must be followed:

1. Do not place the humidifier near a heat source.
2. Never leave the humidifier unattended while connected to the electrical outlet.
3. To avoid any accidents, never cover the Mist Lid when the humidifier is in operation.
4. Use the humidifier on a smooth, flat, lint-free, non-metallic, waterproof, and level surface away from water.
5. Do not unplug from the wall socket by pulling on the supply cord.
6. The humidifier must be unplugged:
  - A. Before either filling or emptying the humidifier.
  - B. Before any cleaning or maintenance is performed.
  - C. After each use.
  - D. If it appears to be faulty.

**THIS PRODUCT IS INTENDED FOR HOUSEHOLD USE ONLY.**

# LIST OF MAIN PARTS

**Fig. 1**

1. Water Level Sensor
2. Nebulizer (Under mist chamber)
3. Mist Chamber

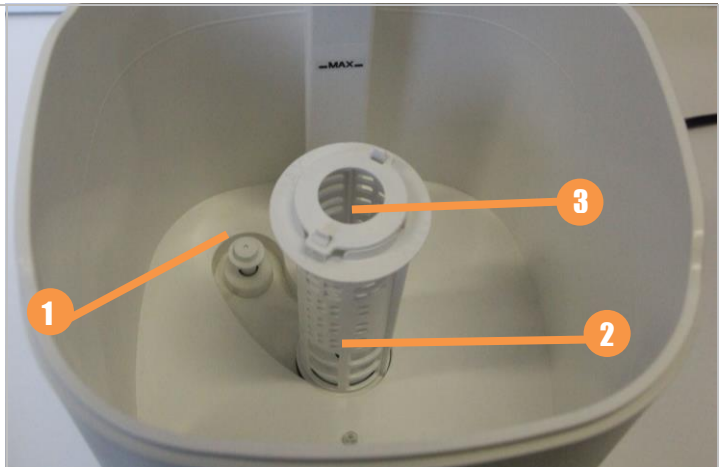

**Fig. 2**

5. Cover
6. Mist Lid
7. Control Buttons
8. Fan Inlet (on back)

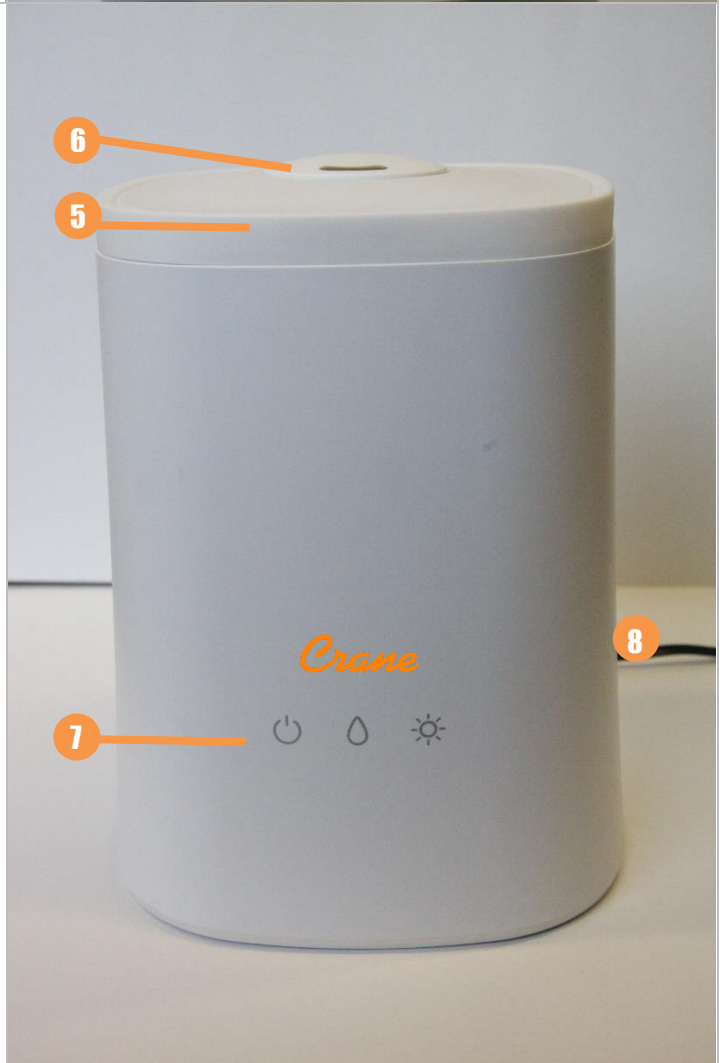

# TECHNICAL SPECIFICATIONS

Rating Voltage	120V
Wattage	37W
Frequency	60Hz
Water Tank Capacity	Approx. 1.2 Gallon
Run Time Per Tank	Up to 24 hours
Humidifying Capacity	Up to 500 sq. ft.
Noise Level	< 37 decibels from 3 ft away

## BEFORE EACH USE:

### CHECK HUMIDIFIER PLACEMENT:

Place the Humidifier on an elevated, non-metallic, lint-free, waterproof, level surface at least 2 feet above the floor.

- **DO NOT PLACE ON CARPET OR TOWEL.** The fan vent is located on the back of the humidifier base. The fan vent **MUST NOT** be obstructed.
- **DO NOT PLACE ON WOOD SURFACE** or near furniture that can be damaged by too much moisture.

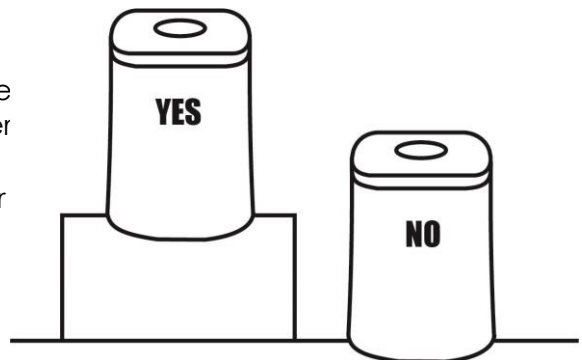

### A NOTE ABOUT HUMIDITY

- To reduce excessive humidity or condensation, especially in small rooms, leave the room door open and adjust mist intensity to the low output setting.
- Too much humidity in the room may allow moisture to accumulate on surfaces where bacteria and fungi can grow. Moisture that gathers may also damage furniture and walls, especially wallpaper.



## CAUTION

- **DO NOT attempt to operate the humidifier without water in the Water Tank.**
- **DO NOT plug or unplug the Power Cord with wet hands as electric shock could occur.**

# ASSEMBLY & USE

**ALWAYS use fresh cool water when operating the humidifier.**

1. Remove the top cover from the main body.
2. Attach the Mist Chamber into the humidifier by placing the chamber directly over the nebulizer and turn clockwise to secure the chamber in place. **DO NOT OPERATE THE HUMIDIFIER WITHOUT THE MIST CHAMBER ATTACHED.**
3. Fill water into the main body. Do NOT exceed the MAX level mark.

**Note: Essential oils may be added to the water.**

**DO NOT** fill water all the way to the rim.  
**DO NOT** use hot water.  
**DO NOT** add any medication or salt.

4. Place top cover on humidifier base, making sure it fits together securely.

**Note:** Do not attempt to move the humidifier while full Water. Doing so may cause leakage of water.

5. Plug the power cord into a wall socket and turn on the unit by using the Control Buttons.
6. POWER:  Touch the button to turn ON/OFF the humidifier.  
1 touch – the unit is ON, the mist is HIGH, the indicator light is GREEN  
**NOTE: The mist chamber must be attached before the unit is turned on.**  
2 touch – the unit if OFF, the light indicator is BLUE

7. MIST OUTPUT:  Touch button to set the mist volume.  
Green Light = High Mist  
Blue Light = Low Mist

8. LIGHT:  Touch the button to turn the LED light ON/OFF and select light mode.  
1 Touch – the LED will change colors continually.  
2 Touch – Keeps the current color on  
3 Touch – Turns OFF the LED light

**Note:** Indicator will be Green when the light function is ON and Blue when the lights are OFF.

9. **SET THE CORRECT HUMIDITY OUTPUT:** Adjust the mist output so the mist rises up to be absorbed by the room air. If mist drops quickly, turn down the mist output to the low setting.
10. When the humidifier runs out of water, the Power Indicator will blink red 3 times and the unit will shut off. This is a safety feature to prevent the humidifier from possibly overheating and damaging the Nebulizer. Unplug the humidifier before removing the top and refilling the humidifier. When emptying the humidifier, be sure to pour away from the fan outlet.





# **MAINTENANCE**

Cleaning and disinfecting on a regular basis is important for maintaining the performance of your humidifier.

**IMPORTANT: Water left in the tank or base when not in use may result in buildup of mineral deposits and bacteria which may inhibit the output efficiency as well as void the warranty. If water remains in the Water Tank for more than a day or two, bacterial growth is possible.**

## **DAILY MAINTENANCE**

1. Turn off, unplug from outlet, remove top and empty water from base daily.
2. Remove the mist chamber and rinse with water, then allow to air dry
3. Allow top & base to air dry.
4. Leave top off the base until ready for next use.

## **WEEKLY MAINTENANCE**

1. Turn off, unplug from outlet and empty water from tank.
2. Wash the top, mist lid and mist chamber with a white vinegar and water solution by wiping each piece and rinsing.

**NOTE: The Top Cover, Mist Chamber and Mist Lid are TOP RACK dishwasher safe.**

3. Fill base half way with warm water, add 2 - 4 tablespoons of white vinegar and let sit for 20 min. Empty base & rinse with plain water. Make sure to pour water away from the fan outlet when emptying. **Do NOT put the base in the dishwasher.**

*TIP: Clean the nebulizer with a damp cloth or cotton swab after soaking.*

**NEVER IMMERSE HUMIDIFIER BASE IN WATER.**

## **END-OF-SEASON MAINTENANCE & STORING YOUR HUMIDIFIER**

1. Turn off, unplug from outlet, and empty water from top & base.
2. Follow instructions for weekly maintenance above.
3. Let all parts dry completely.
4. Store humidifier in a cool, dry place.

# CRANE CUSTOMER CARE

CALL US: 888-599-0992 (Mon-Fri 9:00am – 4:00pm CST)

EMAIL US: [customer-service@crane-usa.com](mailto:customer-service@crane-usa.com)

LIVE CHAT: available at [www.crane-usa.com](http://www.crane-usa.com)

## TROUBLESHOOTING

**DO NOT attempt to repair the motor yourself.**

**If the humidifier continues to not operate, please contact Crane Customer Care.**

Problem	Solution
<b>No mist being Produced</b>	<ul style="list-style-type: none"><li>▪ Ensure the unit is plugged in.</li><li>▪ The base might be overfilled: Remove the top, empty the base &amp; refill.</li><li>▪ Ensure the top is secure on the unit.</li><li>▪ Clean the Water Level Sensor: Pull of the plastic cap from the peg. Remove the water level sensor float and clean with warm sudsy water. Replace parts by first putting the float onto the peg, then replacing the plastic cap on the peg. (Page 4 – Fig. 1)</li></ul>
<b>Humidifier Does Not Have Any Power:</b>	<ul style="list-style-type: none"><li>▪ Ensure unit is properly plugged into a power outlet / try another power outlet.</li><li>▪ Check to make sure the unit is turned ON.</li><li>▪ If Power On indicator light does not come on, contact Customer Care.</li></ul>
<b>There is a Strange Odor:</b>	<ul style="list-style-type: none"><li>▪ Clean the Water Tank with a water &amp; white vinegar solution and rinse with clean water. (Page 7)</li><li>▪ Leave the empty Water Tank open in a cool place for 12 hours without the Water Tank Cap attached.</li></ul>
<b>Air blows, but no mist is being produced:</b>	<ul style="list-style-type: none"><li>▪ Complete the weekly maintenance. (Page 7)</li><li>▪ Humidifier should be placed on a hard, flat surface &amp; fan vent should not be blocked.</li></ul>
<b>White Dust Appears &amp; Settles Outside the Humidifier:</b>	<ul style="list-style-type: none"><li>▪ Area tap water may have too many minerals. Change to distilled water.</li></ul>
<b>Humidifier is Leaking:</b>	<ul style="list-style-type: none"><li>▪ From MIST LID: Turn mist level down</li><li>▪ From BASE: Call Customer Care</li></ul>

**NOTE: Spare Parts can also be purchased online at [www.crane-usa.com](http://www.crane-usa.com)**

# CRANE WARRANTY

For more information regarding the warranty policy,  
please visit our website: [www.crane-usa.com/customer-service](http://www.crane-usa.com/customer-service)

## LIMITED WARRANTY

Thank you for purchasing a Crane product which has been tested to meet our stringent quality standards. This product is warranted to be free from manufacturing defects under normal use and conditions for 1 year.

**PLEASE CONTACT US BEFORE RETURNING THIS PRODUCT TO THE STORE.  
CALL CRANE CUSTOMER CARE FOR PROBLEMS AND QUESTIONS. WE CAN HELP.**

### WARRANTY REQUIRES A DATED PROOF OF PURCHASE.

This warranty is void if the defect is due to accidental damage, misuse, abuse, neglect, improper repair or alteration by unauthorized persons, or a failure to follow operating instructions provided with the product **including the use of essential oils directly into the tank and base**. This warranty does not apply to normal wear and tear or commercial use.

In no event shall liability exceed the purchase price paid by the purchaser of the product. Under no circumstances shall there be liability for any loss – direct, indirect or incidental – or consequential damage arising out of, or in connection with the use of this product.

**This warranty is valid only in the 48 contiguous states plus the District of Columbia** and excludes Puerto Rico and the Virgin Islands. This warranty is effective only if the product is purchased and operated in the United States of America.

Any instructions or warranty included in this manual may be subject to change without notice. For the most up-to-date instructions and warranty information, please contact us or visit our website.

**TO RECEIVE WARRANTY INSTRUCTIONS AND RETURN AUTHORIZATION,  
PLEASE CALL OR EMAIL CRANE CUSTOMER CARE.**

**CRANE USA, INC.**  
1015 Hawthorn Dr., Itasca, IL 60143

Toll Free: 1-888-599-0992 (Monday - Friday 9:00am - 4:00pm CST)  
Email: [customer-service@crane-usa.com](mailto:customer-service@crane-usa.com)  
Website: [www.crane-usa.com](http://www.crane-usa.com)

*Crane*

DESIGN FOR BETTER LIVING